

UPPER GRATE WITH 20 Holes Grates

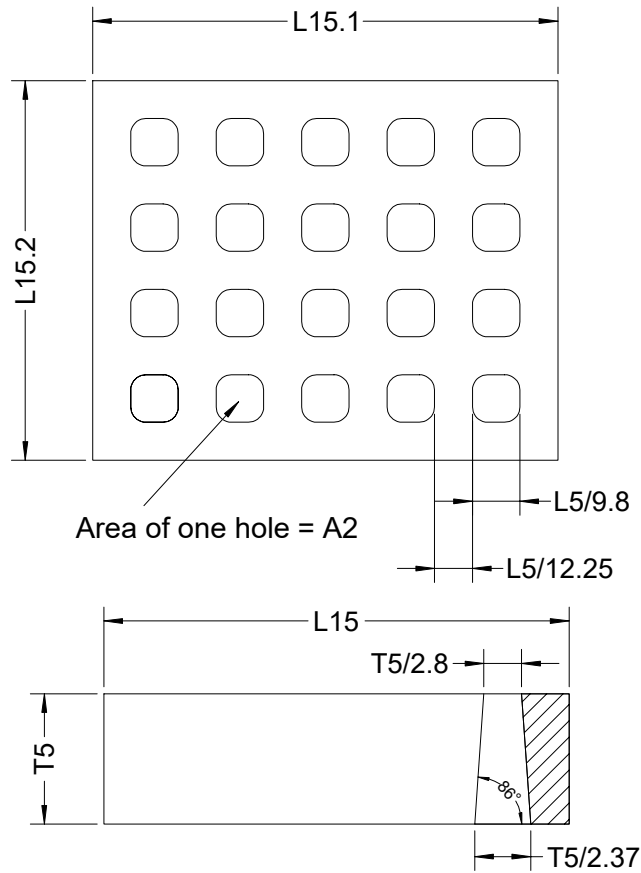

For use with Table of Dimensions for Ugandan Simba Stove 50 to 1000 litres			UG Simba Institutional Stoves
			Features: Castable refractory cement square vibrated fired to Cone 6 clears the recess by 2.5mm on each side
			Material: Castable Refractory Cement
			Quantity: 1 per stove
			Scale: Not to scale
Version: 1.0	Date: 2024-01-20	Initials CPP	Drawn By: C Pemberton-Pigott
Drawing No. UG-Simba-21 Grate w/4 rows			Part Grate