

25 x 5 Flat Bar  
lip for the seal

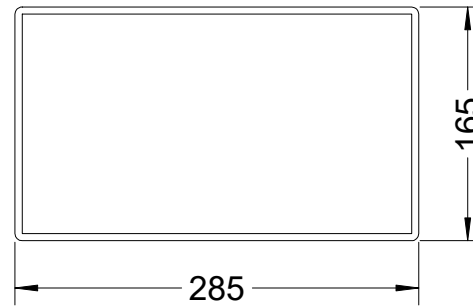

Model KG5  
Version 1.2  
10 Nov 2016

C Pemberton-Pigott

### KG5.1-v1.2-14 Heat Exch cover plate

Side view

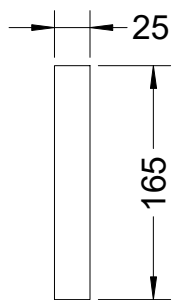

Lip seal is welded  
around the edge of the  
inspection hole

Weld two 40mm M10x1.5  
bolts onto the  
upper side of the plate.

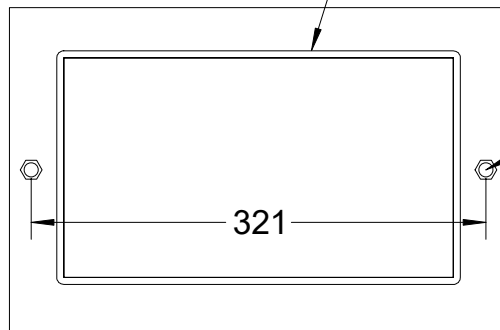

## Heat exchanger cover plate