

HALF SLAB

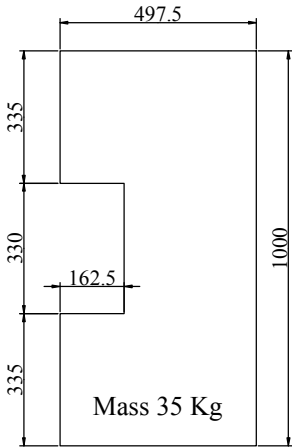

Mass 35 Kg

6 Pieces 460 X R6
3 Pieces 960 x R6

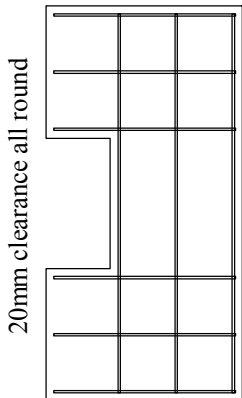

LION STOVE THIN CEMENT HALF SLAB FORM WITH 330 x 330 MM CENTRE HOLE

For use with standard bricks only, i.e. when there are no pavers available to make the top of the combustion chamber

10 Sept 2008

C Pemberton-Pigott

The sheet is placed on the frame first.
The angle iron parts are placed so they tilt taking advantage of the position of the edges of the sheet.
This is calculated to give an outward tilt to the vertical faces so the slab is easy to remove.

DO NOT weld the angle iron parts together flat on another surface and then drop them onto the sheet. They are supposed to be tilted and then welded.

40 x 40 x 6 Angle Iron

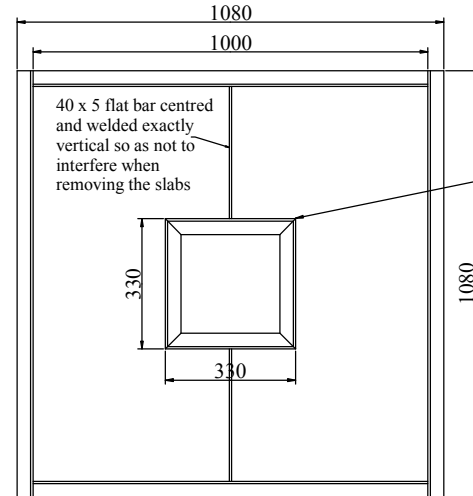

Corner needs fill welding and careful grinding to release the slab easily. Cut sharper at 40 and not 45 deg to make this easier



Tilt of Angle iron caused by sheet metal under the edge of the angle iron.

